

A

B

C

D

E

F

A

B

C

D

E

F

**TECHNICAL SPECIFICATIONS :**  
 MINIMUM / MAXIMUM OPERATING TEMPERATURE : 5 ÷ 70°C  
 MINIMUM / MAXIMUM OPERATING PRESSURE : 0,5 ÷ 7 Bar  
 RECOMMENDED : 3 ÷ 5 Bar

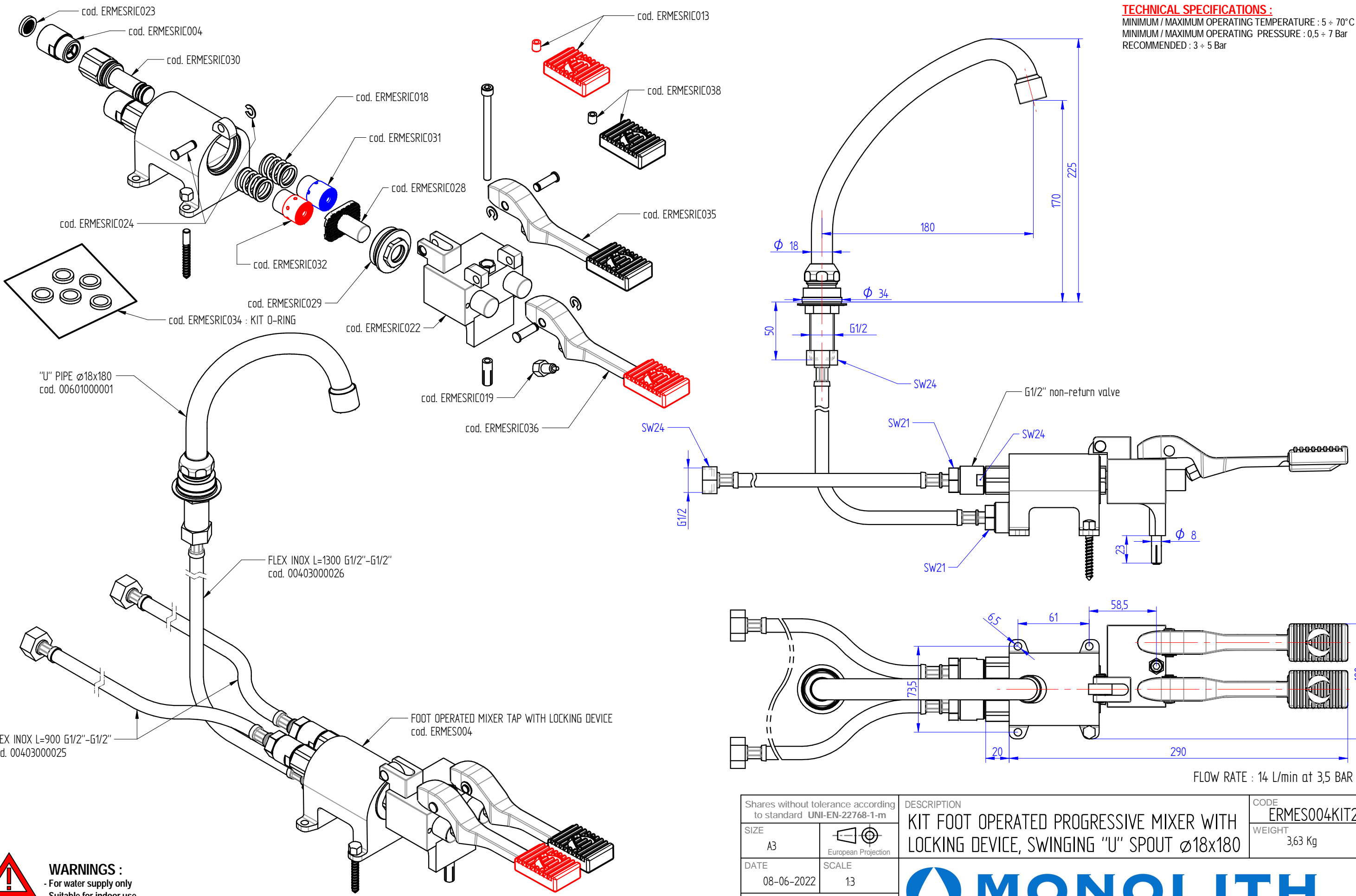

**WARNINGS :**

- For water supply only
- Suitable for indoor use
- Do not use toxic or abrasive products for the tap cleaning
- Install stop valve with filter (recommended) for maintenance operations
- Install filter gaskets (supplied) in the supply line
- Clean the pipes from debris, by to flow the water, before connecting the tap to the supply line
- Installation for release to specialized personnel

Shares without tolerance according to standard UNI-EN-22768-1-m		DESCRIPTION	CODE
SIZE	European Projection	KIT FOOT OPERATED PROGRESSIVE MIXER WITH LOCKING DEVICE, SWINGING "U" SPOUT ø18x180	ERMES004KIT2
A3			WEIGHT
DATE	SCALE		3,63 Kg
08-06-2022	1:3		
DRAWN		 DESIGN AND TECHNOLOGICAL RESEARCH FOR WATER	
PICCOLO M.			
VALIDATE		VIA DELL'ARTIGIANO 8/F-8-G , 31050 MONASTIER DI TREVISO (TV) tel: 0422 842157 - fax: 0422 708978	
PICCOLO M.		DONE WITH DESIGN CAD - PROHIBITED THE CHANGES MANUAL	