

**TECHNICAL SPECIFICATIONS :**

MINIMUM / MAXIMUM OPERATING TEMPERATURE : 5 ÷ 70°C

MINIMUM / MAXIMUM OPERATING PRESSURE : 0,5 ÷ 7 Bar

RECOMMENDED : 3 ÷ 5 Bar

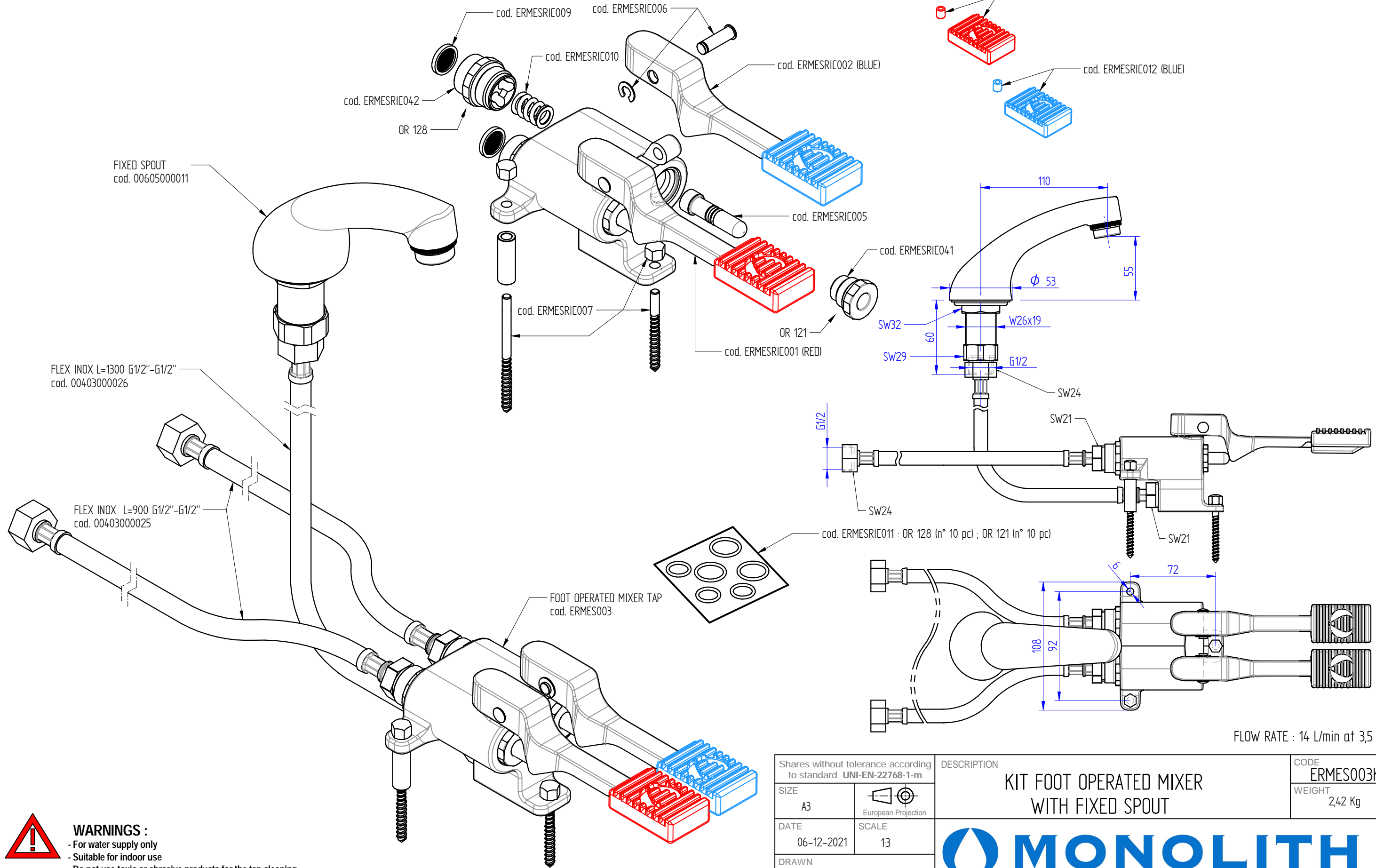

**WARNINGS :**

- For water supply only
- Suitable for indoor use
- Do not use toxic or abrasive products for the tap cleaning
- Install stop valve with filter (recommended) for maintenance operations
- Install filter gaskets (supplied) in the supply line
- Clean the pipes from debris, by to flow the water, before connecting the tap to the supply line
- Installation for release to specialized personnel

Shares without tolerance according to standard UNI-EN-22768-1-m		DESCRIPTION	CODE
SIZE	European Projection	KIT FOOT OPERATED MIXER WITH FIXED SPOUT	ERMES003KIT1
A3			WEIGHT
DATE	SCALE	 <b>MONOLITH</b> DESIGN AND TECHNOLOGICAL RESEARCH FOR WATER	
06-12-2021	1:3		
DRAWN	PICCOLO M.		
VALIDATE	PICCOLO M.	VIA DELL'ARTIGIANO 8/F-8-G , 31050 MONASTIER DI TREVISO (TV) tel: 0422 842157 - fax: 0422 708978	
DONE WITH DESIGN CAD - PROHIBITED THE CHANGES MANUAL			